

# EN

INSTRUCTIONS  
AIR COOLER



EN This product is only suitable for well insulated spaces or occasional use.

**Table of contents**

**Information on the use of these instructions** ..... 2

**Safety** ..... 2

**Information about the device** ..... 6

**Transport and storage** ..... 7

**Assembly and start-up** ..... 7

**Operation** ..... 12

**Available accessories** ..... 15

**Errors and faults** ..... 15

**Maintenance** ..... 16

**Technical annex** ..... 19

**Disposal** ..... 21

**Information on the use of these instructions**

**Symbols**

 **Warning of electrical voltage**  
 This symbol indicates dangers to the life and health of persons due to electrical voltage.

 **Warning**  
 This signal word indicates a hazard with an average risk level which, if not avoided, can result in serious injury or death.

 **Caution**  
 This signal word indicates a hazard with a low risk level which, if not avoided, can result in minor or moderate injury.

**Notice**  
 This signal word indicates important information (e.g. material damage), but does not indicate hazards.

 **Info**  
 Information marked with this symbol helps you to carry out your tasks quickly and safely.

 **Follow the manual**  
 Information marked with this symbol indicates that the instructions must be observed.

You can download the current version of the instructions and the EU declaration of conformity via the following link:

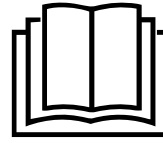

PAE 19 H





<https://hub.trotec.com/?id=46147>

**Safety**

**Read this manual carefully before starting or using the device. Always store the manual in the immediate vicinity of the device or its site of use.**

 **Warning**  
**Read all safety warnings and all instructions.**  
 Failure to follow the warnings and instructions may result in electric shock, fire and/or serious injury.  
**Save all warnings and instructions for future reference.**  
 This appliance can be used by children aged from 8 years and above and persons with reduced physical, sensory or mental capabilities or lack of experience and knowledge if they have been given supervision or instruction concerning use of the appliance in a safe way and understand the hazards involved.  
 Children shall not play with the appliance. Cleaning and user maintenance shall not be made by children without supervision.

 **Warning**  
 Children of less than 3 years should be kept away from the device unless continuously supervised.  
 Children aged from 3 years and less than 8 years shall only switch on/off the appliance provided that it has been placed or installed in its intended normal operating position and they have been given supervision or instruction concerning use of the appliance in a safe way and understand the hazards involved.  
 Children aged from 3 years and less than 8 years shall not plug in, regulate and clean the appliance or perform user maintenance.

 **Warning**  
 Do not use the device in small rooms if persons are present who cannot leave the room independently and who are not under constant supervision.

- Do not use the device in potentially explosive rooms or areas and do not install it there.
- Do not use the device in aggressive atmosphere.

- Let the device dry out after a wet clean. Do not operate it when wet.
- Do not use the device with wet or damp hands.
- Do not expose the device to directly squirting water.
- Do not cover the device during operation.
- Do not sit on the device.
- This appliance is not a toy. Keep away from children and animals. Do not leave the device unattended during operation.
- Occasionally observe the device during operation.
- Check accessories and connection parts for possible damage prior to every use of the device. Do not use any defective devices or device parts.
- Ensure that all electric cables outside of the device are protected from damage (e.g. caused by animals). Never use the device if electric cables or the power connection are damaged!
- The mains connection must correspond to the specifications in the Technical annex.
- Insert the mains plug into a properly fused mains socket.
- Observe the device's power input, cable length and intended use when selecting extensions to the power cable. Completely unroll extension cables. Avoid electrical overload.
- Do not under any circumstances use the device if you detect damages on the mains plug or power cable. If the power cable is damaged, it must be replaced by the manufacturer, its service agent or similarly qualified persons in order to avoid a hazard.  
Defective power cables pose a serious health risk!
- Before carrying out maintenance, care or repair work on the device, remove the mains plug from the mains socket. Hold onto the mains plug while doing so.
- Switch the device off and disconnect the power cable from the mains socket when the device is not in use.
- When positioning the device, observe the minimum distances from walls and other objects as well as the storage and operating conditions specified in the Technical annex.
- Make sure that the air inlet and outlet are not obstructed.
- Make sure that the suction side is kept free of dirt and loose objects.
- Never insert any objects or limbs into the device.
- Do not remove any safety signs, stickers or labels from the device. Keep all safety signs, stickers and labels in legible condition.
- Only transport the device in an upright position with an emptied water tank.
- Empty and clean the water tank prior to storage or transport. Do not drink the water. Health hazard!
- Never leave water in the water tank when the appliance is not in use.
- Make sure that objects in the surroundings of the device do not become wet or damp. If moisture is present, the output must be reduced. Set the device to a lower level. If the output cannot be reduced, the device must only be operated in intervals. If necessary, switch the device off completely for a short time. Ensure that absorbent materials such as carpeting, curtains, sheers or tablecloths will not become damp.
- Note that high humidity levels may enhance the growth of biological organisms in the environment.
- Make sure that the water in the water tank is replaced every 3 days. Otherwise there is a risk of microorganisms growing in the water tank which presents a health hazard if they get into the air or water.
- Only fill the water tank with fresh drinking water, ice cubes made of fresh drinking water and / or suitable ice packs.
- Ice packs are not toys. Keep away from children and animals.
- Never open an ice pack. The liquid inside the ice packs can be harmful to health.
- Do not eat the ice that may form on the ice packs. Health hazard!
- Do not use this device near bathtubs, shower trays, swimming pools or other water containers. Risk of electric shock!
- Do not use the device if it has been dropped or if it shows visible signs of damage.
- Make sure that the device does not touch any objects during operation.
- Do not position the device near windows or in direct sunlight.
- Do not use the device together with other semiconductors.
- Keep a safety distance of at least 1 m between the air inlet and the air outlet of the device and all combustible materials such as textiles, curtains, beds and sofas.
- Only use original spare parts, for otherwise safe and functional operation cannot be ensured.
- Allow the device to cool down before transport and/or maintenance work.
- The device must not be positioned directly beneath a wall socket.
- Do not use the device together with a programming device, a timer, a separate remote control system or any other device that automatically switches the device or the heating function on, as there is a risk of fire if the device is covered or incorrectly positioned.

- Use the CR 2032 button battery type.
- Do not insert rechargeable batteries into the remote control.
- Never charge batteries that cannot be recharged.
- Different types of batteries and new and used batteries must not be used together.
- Insert the batteries into the battery compartment according to the correct polarity.
- Remove discharged batteries. Batteries contain materials hazardous to the environment. Dispose of the batteries according to the national regulations.
- Remove the batteries from the remote control if you will not be using the device for a longer period of time.
- Never short-circuit the supply terminal in the battery compartment!
- Do not swallow batteries! If a battery is swallowed, it can cause severe internal burns within 2 hours! These burns can lead to death!
- If you think batteries might have been swallowed or otherwise entered the body, seek medical attention immediately!
- Keep new and used batteries and an open battery compartment away from children.
- If the battery compartment does not close securely, stop using the product via the remote control.
- Switch the device off and disconnect the power cable from the mains socket before cleaning the device or before filling the water tank with water.

### Intended use

Only use the device for the air cooling, ventilation and heating of interior spaces while adhering to and following the technical data.

The device is only suitable for well insulated spaces or occasional use.

Intended use comprises the air cooling, ventilation and heating of:

- living spaces
- museums
- warehouses and archives
- libraries
- call centres and computer rooms

Any use other than the intended use is regarded as misuse.

Only use the device for drying and dehumidifying room air, while adhering to and following the technical data.

Intended use comprises:

- dehumidifying and drying:
  - building shells
  - premises e. g. after water damage (water damage restoration)
- maintaining the dryness of:
  - storage spaces, archives, laboratories, garages
  - holiday homes
  - changing rooms etc.

Any use other than the intended use is regarded as misuse.

### Reasonably foreseeable misuse

- Do not place the device on wet or flooded ground, e.g. near floor drains.
- Do not place any objects, e.g. clothing, on the device.
- Do not use the device out of doors.
- Do not use the device in the immediate vicinity of swimming pools, bathtubs and showers.
- Do not use this device in the vicinity of fuel, solvents, varnishes or other easily inflammable vapours or in rooms where these substances are stored.
- Never immerse the device in water.
- Do not use the device for heating in vehicles.
- Never heat rooms with a cubature of less than 4 m<sup>3</sup>. Risk of overheating!
- Never immerse the device in water.
- Do not make any unauthorised modifications, alterations or structural changes to the device.

### Personnel qualification

People who use this device must:



- be aware of the dangers that occur when working with electric devices in damp areas.
- have read and understood the instructions, especially the Safety chapter.

## Safety signs and labels on the device

### Notice

Do not remove any safety signs, stickers or labels from the device. Keep all safety signs, stickers and labels in legible condition.

The following safety signs and labels are attached to the device:

Symbols	Meaning
	This symbol located on the device indicates that the filter has to be checked and, if necessary, to be cleaned prior to each operation. Replace the filter if it is defective. Do not insert a wet filter into the device. Wait until the filter has dried.
	This symbol located on the device indicates that the water tank should be cleaned every 3 days. Change the water in the water tank every 3 days. Disconnect the device from the mains before cleaning the water tank.

## Residual risks



### Warning of electrical voltage

Work on the electrical components must only be carried out by an authorised specialist company!



### Warning of electrical voltage

Risk of electric shock!

The device is not protected against water.

There is a risk of electric shock!

Never use the device in areas where dripping, spraying or running water can enter the device! Never immerse the device in water!



### Warning of electrical voltage

Risk of electric shock!

Risk of an electric shock if the device comes into contact with water!

Do not use this device in the immediate vicinity of bathtubs, showers or swimming pools!



### Warning of electrical voltage

Before any work on the device, remove the mains plug from the mains socket!

Do not touch the mains plug with wet or damp hands.

Hold onto the mains plug while pulling the power cable out of the mains socket.



### Warning

The liquid inside the ice packs can be harmful to health!

If the liquid was swallowed, immediately seek medical attention.

If the liquid came into contact with your eyes, rinse with water and immediately consult an ophthalmologist.



### Warning

Dangers can occur at the device when it is used by untrained people in an unprofessional or improper way! Observe the personnel qualifications!



### Warning

The device is not a toy and does not belong in the hands of children.



### Warning

Risk of suffocation!

Do not leave the packaging lying around. Children may use it as a dangerous toy.



### Warning of hot surface

Parts of this appliance can become very hot and cause burns. Particular attention is to be paid when there are children or vulnerable persons present!



### Warning

In order to avoid overheating and fire hazards, the device must not be covered!



### Warning

Improper installation or mounting entails a risk of fire.

Do not place the device on combustible ground.

Do not place the device on high-pile carpets.

Only use the device as intended.

### Notice

Do not operate the device without an air filter inserted into the air inlet!

Without the air filter, the inside of the device will be heavily contaminated. This can reduce the performance and result in damage to the device.

## Behaviour in the event of an emergency

1. Switch the device off.
2. Disconnect the device from the mains: Hold onto the mains plug while pulling the power cable out of the mains socket.
3. Do not reconnect a defective device to the mains.

## Overheating protection

The device is provided with a safety thermostat, which is activated by overheating of the device (when exceeding the operating temperature).

Once the safety thermostat has switched itself on, the heating will be turned off.

When the safety thermostat is activated, allow the device to cool down. Only then start to look for the cause of overheating.

Should the problem persist, please contact the customer service.

**Information about the device**

**Device description**

The air cooler lowers the room temperature to a comfortable degree by evaporation-based cooling.

The device is filled with cold water or optionally with ice cubes and / or ice packs in order to cool down the incoming warm air at the evaporation filter and to blow out the cold air thus generated via the fan.

Besides its cooling function, the device can also be used for air freshening: thanks to an integrated air filter and the evaporation filter's honeycomb structure, the sucked-in air is filtered and humidified.

The fan speed can be set to three stages.

Furthermore, the device is equipped with a heating function for generating warm air via a heating element. The heated air is blown into the room by a fan. The heating capacity can be adjusted on two heating levels.

The discharge direction of the air can be manually adjusted via the ventilation flaps as well as via the optionally selectable automatic swing mode.

The device has a night mode enabling ultra-silent operation at bedtime.

The device can be operated via the control panel at the device or via the infrared remote control.

Moreover, using the timer function, the device can be switched off automatically with time delay.

**Device depiction**

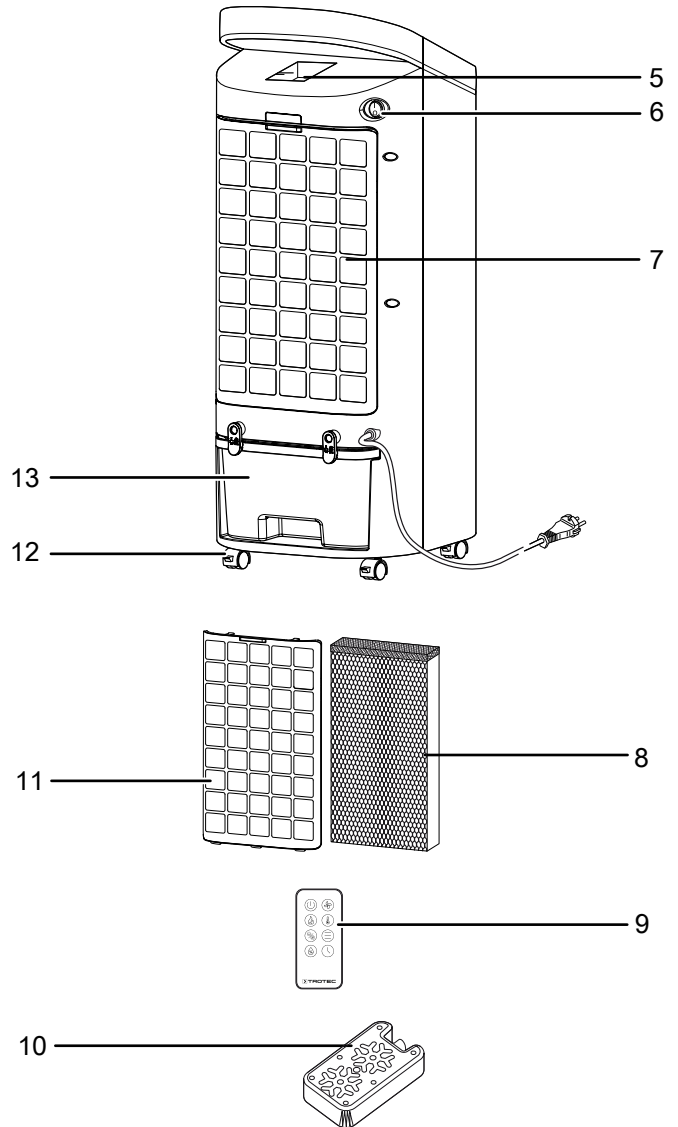
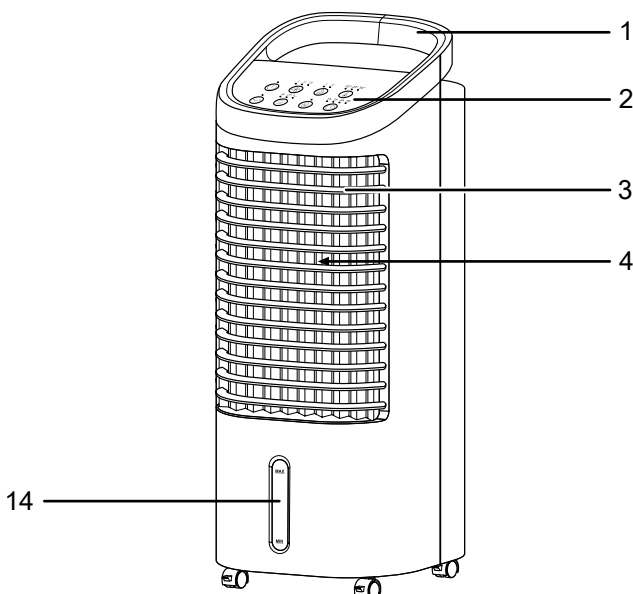

No.	Designation
1	Transport handle
2	Control panel
3	Air outlet with adjustable ventilation flaps
4	Air flaps for swing function
5	Compartment for the remote control
6	On/off switch
7	Air inlet with air filter and evaporation filter
8	Evaporation filter
9	Remote control
10	Ice pack
11	Air filter
12	Wheels (rear wheels wheels with parking brakes)
13	Water tank with locking clips
14	Filling level indicator of the water tank

## Transport and storage

### Notice

If you store or transport the device improperly, the device may be damaged.

Note the information regarding transport and storage of the device.

### Transport

To make the device easier to transport, it is fitted with wheels.

To make the device easier to transport, it is fitted with a carry handle.

**Before** transporting the device, observe the following:

- Switch the device off.
- Hold onto the mains plug while pulling the power cable out of the mains socket.
- Empty the water tank.
- Do not use the power cable to drag the device.
- Only wheel the device on firm and level surfaces.

**After** transporting the device, proceed as follows:

- Set up the device in an upright position after transport.

### Storage

**Before** storing the device, proceed as follows:

- Empty and clean the water tank prior to storage (see chapter Maintenance).
- Allow the evaporation filter to dry prior to storage. Otherwise the device may distribute a musty smell after restart.
- Hold onto the mains plug while pulling the power cable out of the mains socket.
- Allow the device to cool down sufficiently.

When the device is not being used, observe the following storage conditions:

- Store the device in a dry location and protected from frost and heat.
- Store the device in an upright position where it is protected from dust and direct sunlight.
- If required, use a cover to protect the device from invasive dust.
- Remove the batteries from the remote control.

The power cable can be reeled around the clips on the water tank for storage. To do so, please proceed as follows:

1. Turn the clips on the water tank into a horizontal position.
2. Wrap the power cable completely around the two clips.

## Assembly and start-up

### Scope of delivery

- 1 x Device
- 1 x Evaporation filter
- 1 x Air filter
- 1 x Ice pack
- 1 x Remote control (without batteries)
- 1 x Manual

### Unpacking the device

1. Open the cardboard box and take the device out.
2. Completely remove the packaging.
3. Fully unwind the power cable. Make sure that the power cable is not damaged and that you do not damage it during unwinding.

### Start-up

When positioning the device, observe the minimum distance from walls or other objects as described in the chapter Technical annex.

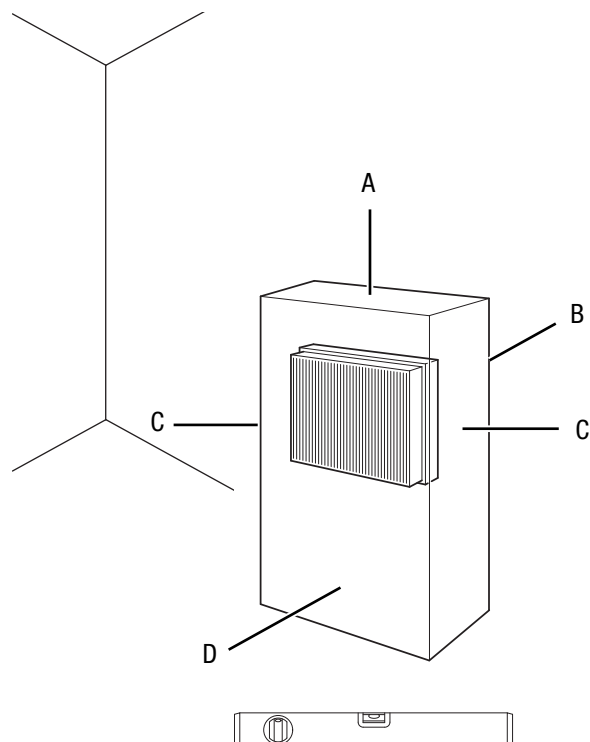

- Before restarting the device, check the condition of the power cable. If there are doubts as to the sound condition, contact the customer service.
- Place the device in an upright and tilt-proof position onto a stable, load-bearing, even substrate that is insensitive to heat.

- Do not create tripping hazards when laying the power cable or other electric cables, especially when positioning the device in the middle of the room. Use cable bridges.
- Make sure that extension cables are completely unrolled.
- Make sure that no curtains or other objects interfere with the air flow.
- Do not position the device directly below a wall socket.
- Put up the device in a way that no person, animal or plant is positioned in its direct flow path upon switch-on.
- Make sure that the device cannot come into contact with moisture or water.

Observe the following before operating the device after a period of non-use or after the device has been stored:

- Clean the housing and the water tank prior to recommissioning (see chapter Maintenance).

**Inserting the battery into the remote control**



**Warning of electrical voltage**

Do not touch the battery compartment with wet or damp hands.

**Notice**

Do not use rechargeable batteries!  
Observe the Technical data for start-up.

Please proceed as follows to insert or exchange the battery:

1. Press the locking at the side of the battery compartment (15) together and pull the battery compartment out of the remote control.
2. Insert a type CR 2032 battery into the battery compartment (15) and slide the battery compartment back into the remote control.

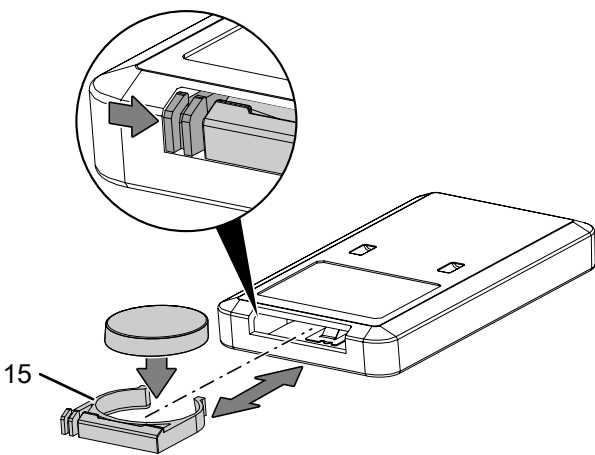

**Mounting the wheels**

To ensure simple transportation and a stable position, the supplied wheels must be mounted. To do so, please proceed as follows:

**Notice**

When mounting the wheels, make sure that the filled water tank is not located inside the device.

1. Place the device on its side and insert a roller (12). Repeat this step for the 3 remaining wheels.  
⇒ Please note that the wheels equipped with a parking brake (16) ought to be positioned at the front of the device.

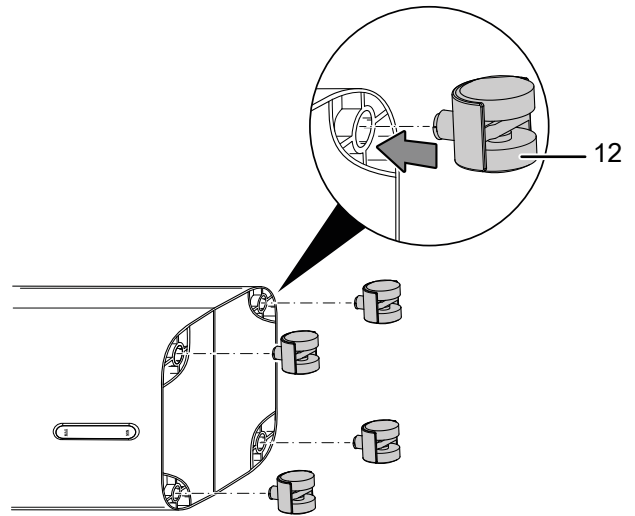

- To facilitate easy transport, release the parking brakes (16).

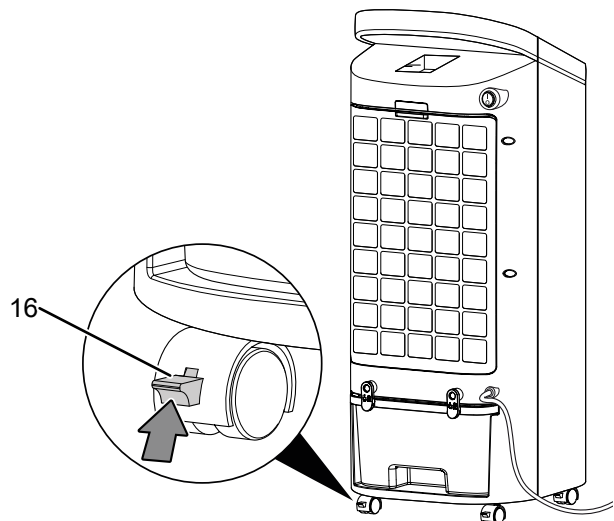



- To ensure a firmly fixed position, apply the parking brakes.

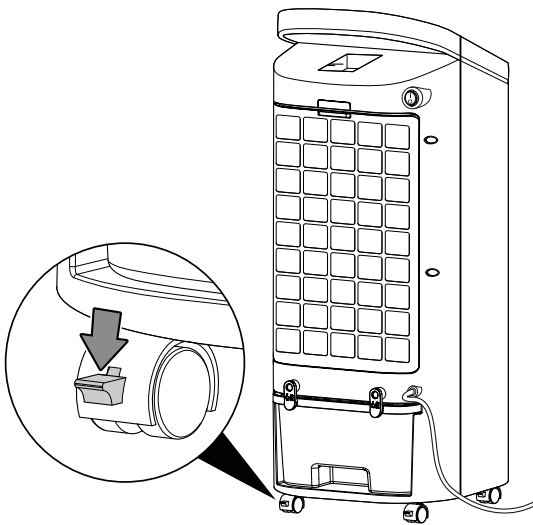

1. Disconnect the device from the mains before refilling water or putting ice packs into the device.
2. Release the water tank (13) by turning the clips from their vertical position into the horizontal position towards the outside.

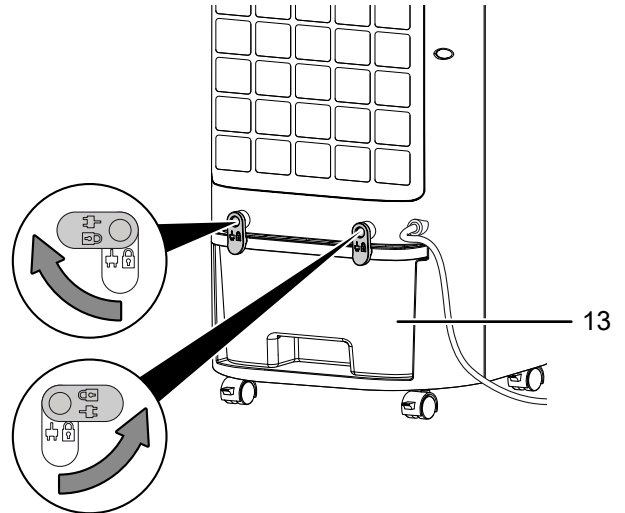

### Filling the water tank

The device requires fresh drinking water for air cooling.



#### Warning of electrical voltage

Before any work on the device, remove the mains plug from the mains socket!

Do not touch the mains plug with wet or damp hands. Hold onto the mains plug while pulling the power cable out of the mains socket.

#### Notice

Fill the device with fresh drinking water only. The water temperature must not exceed 40 °C.



#### Info

If possible, change the water every 3 days to prevent bacterial growth.



#### Info

Optionally, you can put ice packs into the water tank for additional cooling.

Observe the following when using the ice packs:

- Put the ice packs into a freezer for at least 4 hours before use.
- Put the ice packs into the water tank before filling water into the tank.



#### Info

When using ice packs at high outside temperatures, condensation may form at the water tank and drip onto the floor.

3. Remove the water tank (13) from the device.

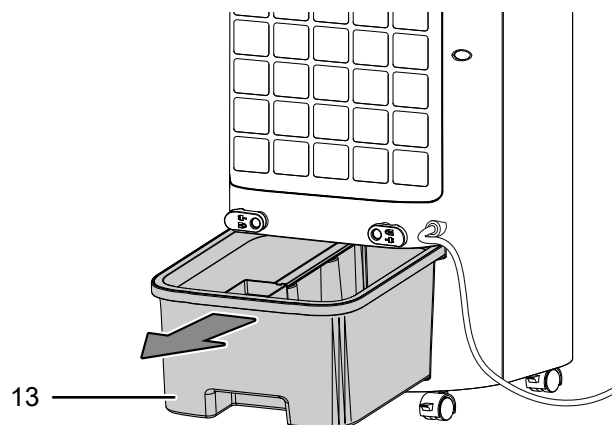

4. If required, put the ice packs (10) into the water tank (13) for additional cooling.

⇒ Observe the labelling on the bottom of the water tank. The ice packs can only be inserted into one side. Otherwise, the pump is blocked.

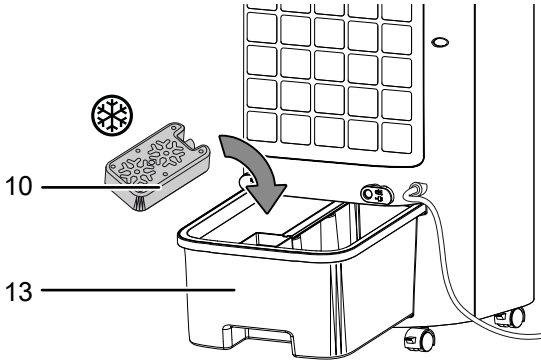

5. Fill the water tank with fresh drinking water only (13). Optionally, you can add ice cubes made of drinking water for additional cooling.

⇒ Observe the minimum and maximum filling level at the filling level indicator (14). The water tank must be filled up to minimum filling level to enable pump operation.

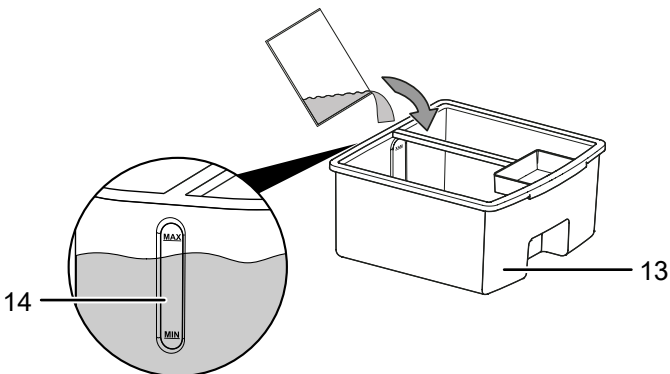

6. Reinsert the water tank (13).

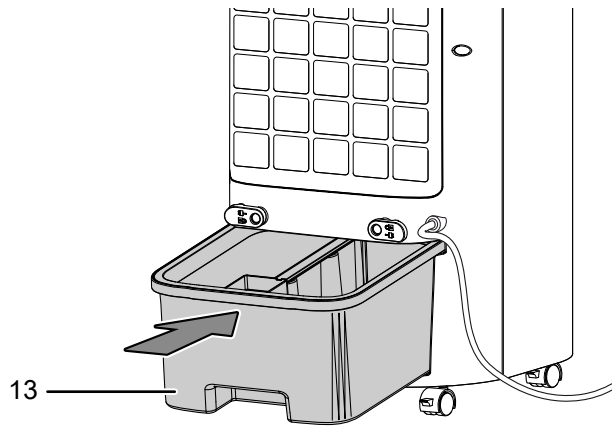

7. Lock the water tank (13) with the clips by turning them from their horizontal position into the vertical position.

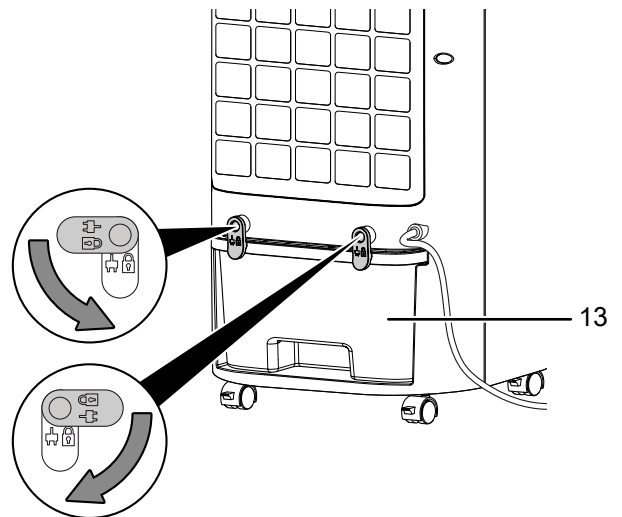

8. Make sure that the device is neither damp nor wet on the outside. Otherwise wipe it dry.

## Inserting evaporation filter and air filter

### Notice

When set to air cooling mode, the device must not be operated without the evaporation filter, otherwise *cooling* will not work.

### Notice

Do not operate the device without an air filter inserted into the air inlet!

Without the air filter, the inside of the device will be heavily contaminated. This can reduce the performance and result in damage to the device.

### Notice

For an even distribution of water please make sure that the top section of the evaporation filter is positioned at the top.

- Make sure that both the evaporation and the air filter are installed before switching the device on.

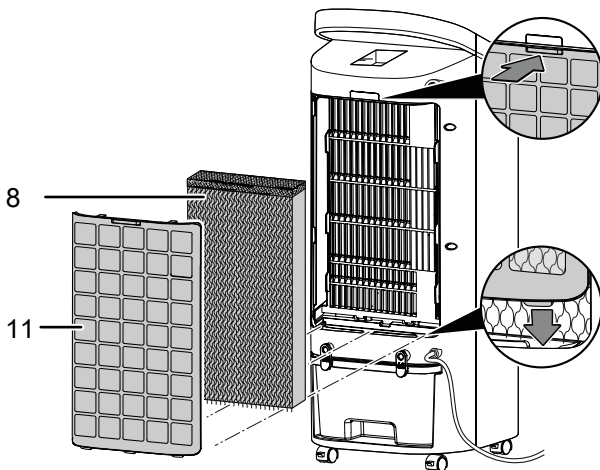

## Adjusting the ventilation flaps

- Prior to switching the device on, adjust the ventilation flaps at the air outlet.

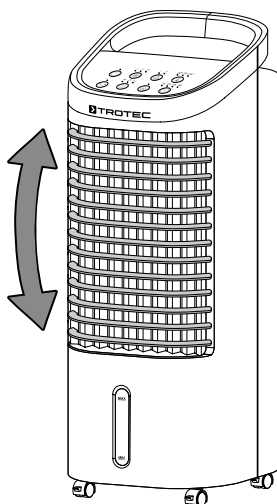

## Connecting the power cable

- Insert the mains plug into a properly fused mains socket.

**Operation**

- Avoid open doors and windows.

**Control panel**

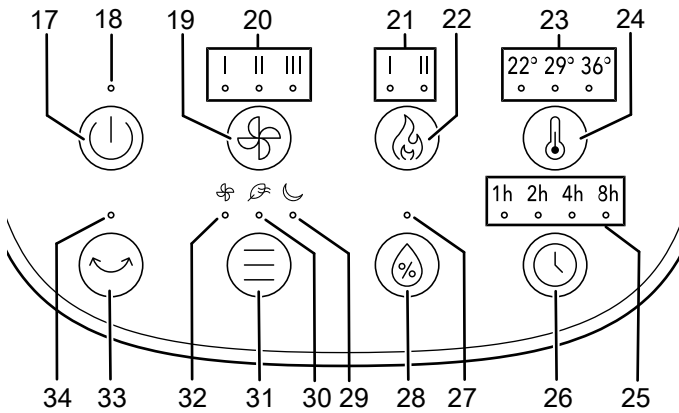

No.	Designation	Meaning
17	On / Off button	Switching the device on or off
18	On LED	Illuminated when the device is switched on
19	Speed button	Setting the fan speed Press the key for 3 seconds to switch on the filter drying function
20	Fan speed LEDs	Fan speed indication I stage 1 = low II stage 2 = medium III stage 3 = high
21	Heating function LEDs	Heating level indication I Level 1 = 1400 W II Level 2 = 2000 W
22	Heating function button	Switching on the heating function
23	Temperature preselection LEDs	Temperature preselection indication 22 °C 29 °C 36 °C
24	Temperature preselection button	Selecting the maximum temperature
25	Hours LEDs	Illuminated when timer for automatic switch-off is activated
26	Timer button	Switching the timer function on or off: 1 h, 2 h, 4 h, 8 h
27	Air cooling LED	Illuminated when air cooling mode is activated
28	Air cooling button	Switching the air cooling mode on or off

No.	Designation	Meaning
29	Night mode LED	Illuminated when night mode is activated.
30	Air freshening LED	Illuminated when air freshening mode is activated
31	Mode button	Selection button for ventilation, air freshening and night mode
32	Ventilation LED	Illuminated when ventilation mode is activated
33	Swing button	Switching the swing function on or off
34	Swing LED	Illuminated when swing function is activated

**Remote control**

All settings of the device can also be made using the remote control included in the scope of delivery.

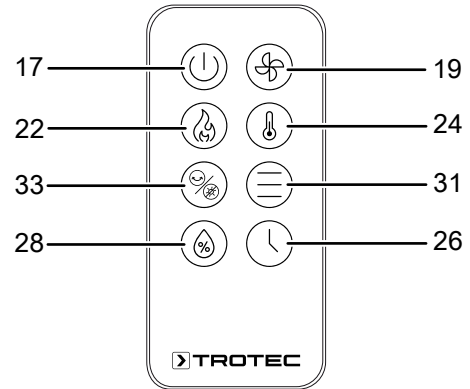

No.	Designation	Meaning
17	On / Off button	Switching the device on or off
19	Fan speed button	Setting the fan speed/ switching on the filter drying function
22	Heating function button	Switching on the heating function
24	Temperature preselection button	Selecting the maximum temperature
26	Timer button	Switching the timer function on or off: 1 h, 2 h, 4 h, 8 h
27	Air cooling button	Switching on air cooling mode
30	Mode button	Selection button for ventilation, air freshening and night mode
33	Swing button	Switching swing function on or off/ switching control panel lighting off



### Warning of electrical voltage

Risk of electric shock!

The device is not protected against water.

There is a risk of electric shock!

Never use the device in areas where dripping, spraying or running water can enter the device! Never immerse the device in water!

### Switching the device on

Once you have completely installed the device as described in the chapter Assembly and start-up, you can switch it on.

1. Press the on/off switch (6) into position I.  
⇒ The device is now in standby mode.
2. Press the *on/off* button (17).  
⇒ An acoustic signal is emitted.  
⇒ The device starts in ventilation mode at fan stage 1.  
⇒ The *On* 18, *Ventilation* (32) and *Fan stage 1* LEDs (20) are lit.

### Setting the operating mode

The device comes with the following operating modes:

- Air cooling
- Ventilation
- Air freshening
- Night mode
- Heating function

You can switch from an active operating mode to any of the other operating modes.

### Air cooling

The air cooling mode can be switched on in addition in the ventilation, air freshening and night mode.

During air cooling the pump is switched on and the water is distributed over the evaporation filter to cool and humidify the circulating air.

Please proceed as follows to activate air cooling:

- ✓ The water tank (13) must be filled up with water at least to the minimum filling level.
1. Press the *Air cooling* button (28).  
⇒ The *Air cooling* LED (27) is illuminated.  
⇒ The pump starts.
  2. Press the *Fan speed* button (19) to set the desired fan stage (1 to 3).
  3. Press the *Air cooling* button (28) again if you wish to switch off the *Air cooling*.  
⇒ The *Air cooling* LED (27) goes out.  
⇒ The device continues to run in the previously selected operating mode with the pump being switched off, the fan stage is maintained.

You can switch on the heating function in air cooling mode.

### Notice

When the Air cooling mode is activated, the air and evaporation filter must not be removed, otherwise the water from the filter will drip down into the device.

### Notice

If there is only a small quantity or no water in the water tank, the air cooling mode is switched off after 45 seconds and an acoustic warning signal is emitted.

### Ventilation

In ventilation mode, you can select all 3 fan speeds manually.

Please proceed as follows to adjust the fan speed:

1. Press the *Mode* button (31) until the *Ventilation* LED (32) is lit.
2. To adjust the fan stage, press the *Fan speed* button (19) until the LED for the desired *Fan speed* (20) is lit.

### Air freshening

In *Air freshening* mode, the fan speed increases and decreases alternately to generate a pleasant, natural air stream.

Please proceed as follows to activate *air freshening*:

1. Press the *Mode* button (31) until the *Air freshening* LED (30) is lit.  
⇒ The fan stages are automatically adjusted.

### Night mode

In night mode, the device operates using a preset programme with different fan speeds to generate an air stream that is adapted to human sleeping habits.

Night mode can be activated in combination with the 3 fan stages and *air cooling*.

- At fan stage 1, the device runs permanently at this stage.
- At fan stage 2, the device automatically switches to fan stage 1 after an operating time of 30 minutes and keeps running at this speed.
- At fan stage 3, the device automatically switches to fan stage 2 after an operating time of 30 minutes. After another 30 minutes, the device automatically switches to fan stage 1 and runs permanently at this stage.

Proceed as follows to switch on the *Night mode*:

1. Press the *Mode* button (31) until the *Night mode* LED (29) is illuminated.
2. Press the *Fan speed* button (19) until the LED for the desired *Fan speed* (20) is lit.

## Heating function

In the Heating function mode, the device generates a warm air stream.

1. Press the *Heating function* button (22) until the LED for the desired heating level (21) is lit.  
⇒ The device runs on the heating level selected.
2. To switch off the heating function, press the *Heating function* button (22) until the LEDs for the heating level (21) go out.  
⇒ The heating function mode is switched off.

### Notice

After switch-off, the fan continues running for approx. 10 seconds to cool down the device and to prevent overheating.

## Temperature preselection

The temperature can be set to 22 °C, 29 °C and 36 °C.

1. Press the *Temperature preselection* button (24) until the LED for the desired temperature (23) is lit.
2. To switch off the temperature preselection, press the *Temperature preselection* button (24) until the LEDs for the temperature (23) go out.

The room thermostat controls the room temperature automatically:

- When exceeding the set value, both the heating and the ventilation will be switched off.
- When falling below the set value, both the heating and the ventilation will automatically be switched back on.

## Setting the timer

The function can be set in addition in all operating modes.

The number of hours can be set to 1 h, 2 h, 4 h or 8 h.

## Automatic switch-off

- ✓ The device is switched on.
1. Press the *Timer* button (26) until the desired number of hours is indicated by the *Hours* LEDs (25).  
⇒ The timer setting equals the desired number of hours.  
⇒ The device switches off automatically after the set number of hours has elapsed.

Notes regarding automatic switch-off:

- Pressing the *On/Off* button (17) deactivates the automatic switch-off function.

## Swing function

The swing function can be switched on in any operating mode if required.

With the swing function being switched on, the vertical air flaps move automatically and ensure continuous air circulation.

1. Press the *swing* button (33) to switch the swing function on or off.

## Memory function

If you switch the device back on from standby mode, the settings selected for the operating mode and swing function are saved. Any activated timer, air freshening and the night mode will not be saved in the device.

## Adding water

For filling the water tank, proceed as described in the "Filling the water tank" section.

## Evaporation filter drying function



### Info

With the drying function you can also dry damp textiles, like for example curtains.

### Notice

Keep a safety distance of at least 1 m between the air inlet and the air outlet of the device and all combustible materials such as textiles, curtains, beds and sofas.

Carry out the evaporation filter drying function prior to storage.

To do so, please proceed as follows:

1. Press the *Fan speed* button on the control panel or the remote control for 3 seconds (19).  
⇒ The device switches to the highest fan stage for 20 min and then automatically switches to standby.  
⇒ The LED for fan stage 3 (20) flashes.  
⇒ No other functions or operating modes can be switched on.
2. Press the button *On/Off* (32) on the control panel or the remote control if you like to terminate the evaporation filter drying function prematurely.

## Shutdown



### Warning of electrical voltage

Do not touch the mains plug with wet or damp hands.

- Switch off the device.
- Hold onto the mains plug while pulling the power cable out of the mains socket.
- Empty and clean the water tank (see chapter Maintenance).
- Clean the device according to the Maintenance chapter.
- Store the device according to the Transport and storage chapter.

## Available accessories



### Warning

Only use accessories and additional equipment specified in the instructions.  
Using insertion tools or accessories other than those specified in the instructions may cause a risk of injury.

Designation	Article number
Evaporation filter PAE 19 H	7.710.000.968

## Errors and faults

The device has been checked for proper functioning several times during production. If malfunctions occur nonetheless, check the device according to the following list.

### Notice

Wait for at least 3 minutes after maintenance and repair work. Only then switch the device back on.

### The device does not start:

- Check the power connection.
- Check the power cable and mains plug for damage.
- Check the on-site fusing.

### The device works with reduced or no capacity:

- Check the position of the horizontal ventilation flaps. They should be opened to the maximum.
- Check the air filter for dirt. If necessary, clean or replace the air filter.
- Check the minimum distance to walls or other objects. Position the device a little more in the room's centre if required.

### The device is running, but there is no air cooling or pump operation:

- Check whether *air cooling* mode is activated.
- Check the filling level of the water tank (see Filling the water tank).
- Check whether there are any objects blocking the pump inlet. Make sure that the pump inlet is not blocked.
- In case the pump does not operate despite a correctly filled water tank and activated air cooling mode, the pump might be defective. Please contact the customer service.

### The device is switched on, but the heating function is not working:

- Check the room temperature. The room thermostat may have switched off, because the desired room temperature has been reached.
- Check whether the overheating protection has tripped (see chapter Safety).

- The heating resistor might have blown. Have a defective heating resistor replaced by a specialist electrical company.
- The room thermostat might be defective. Have a defective room thermostat replaced by a specialist electrical company.
- The heating element may be defective. If the heating element is defective, have it replaced by a specialist electrical company.

### Water is leaking:

- Check the device for leaks.
- Check the water tank for tight fit.

### The swing function is not working:

- The swing function motor might be defective. Please contact the customer service.

### The device does not respond to the infrared remote control:

- Check whether the distance between remote control and device is too large and reduce it if necessary.
- Make sure there are no obstacles, such as furniture or walls, between the device and the remote control. Ensure visual contact between device and remote control.
- Check the charging status of the batteries and change them if required.
- If the batteries have just been changed, check them for correct polarity.

### The device still does not operate correctly after these checks:

Please contact the customer service. If necessary, bring the device to an authorised specialist electrical company or to Trotec for repair.

## Maintenance

## Maintenance intervals

Maintenance and care interval	before every start-up	as needed	every 3 days	at least every 2 weeks	at least every 4 weeks	at least annually
Clean the water tank			X			
Check air inlets and outlets for dirt and foreign objects and clean if necessary	X				X	
Clean the exterior		X				X
Visually check the inside of the device for dirt		X				X
Check the air filter for dirt and foreign objects and clean if necessary	X			X		
Replacing the evaporation filter		X				
Check for damage	X					
Check the attachment screws		X				X
Test run						X

## Maintenance and care log

Device type: .....

Device number: .....

Maintenance and care interval	1	2	3	4	5	6	7	8	9	10	11	12	13	14	15	16
Clean the water tank																
Check air inlets and outlets for dirt and foreign objects and clean if necessary																
Clean the exterior																
Visually check the inside of the device for dirt																
Check the air filter for dirt and foreign objects and clean if necessary																
Replacing the evaporation filter																
Check for damage																
Check attachment screws																
Test run																
Remarks:																

1. Date: .....	2. Date: .....	3. Date: .....	4. Date: .....
Signature: .....	Signature: .....	Signature: .....	Signature: .....
5. Date: .....	6. Date: .....	7. Date: .....	8. Date: .....
Signature: .....	Signature: .....	Signature: .....	Signature: .....
9. Date: .....	10. Date: .....	11. Date: .....	12. Date: .....
Signature: .....	Signature: .....	Signature: .....	Signature: .....
13. Date: .....	14. Date: .....	15. Date: .....	16. Date: .....
Signature: .....	Signature: .....	Signature: .....	Signature: .....



## Activities required before starting maintenance



### Warning of electrical voltage

Do not touch the mains plug with wet or damp hands.

- Switch the device off.
- Hold onto the mains plug while pulling the power cable out of the mains socket.



### Warning of electrical voltage

**Tasks which require the device to be opened must only be carried out by authorised specialist companies or by Trotec.**

## Visual inspection of the inside of the device for dirt

1. Remove the air filter.
2. Use a torch to illuminate the openings of the device.
3. Check the inside of the device for dirt.
4. If you see a thick layer of dust, have the inside of the device cleaned by a specialist electrical company or by Trotec.
5. Put the air filter back in.

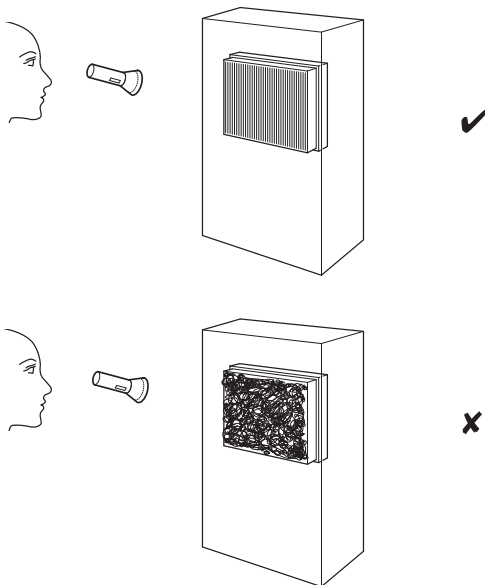

## Cleaning the housing

Clean the housing with a soft, damp and lint-free cloth. Make sure that no moisture enters the housing. Protect electrical components from moisture. Do not use any aggressive cleaning agents such as cleaning sprays, solvents, alcohol-based or abrasive cleaners to dampen the cloth.

## Cleaning the water tank



### Warning

Use citric acid as cleaning/descaling agent for the water tank. Always wear gloves and protection glasses when cleaning the device since the acid may have caustic effects. Additionally, please observe the manufacturer's specifications and hazard warnings for citric acid.



### Notice

Clean the device with citric acid if you detect visible signs of limescale. To clean the device, heat it to max. 40 °C. Otherwise, the formation of citrate may cause damages to the device.

The water tank should be cleaned every 3 days if actively used. Empty and clean the water tank before a longer period of non-use or storage and prior to recommissioning (e.g. if the unit has been stored for several months and is dusty).

1. Release the water tank (13) by turning the clips from their vertical position into the horizontal position.

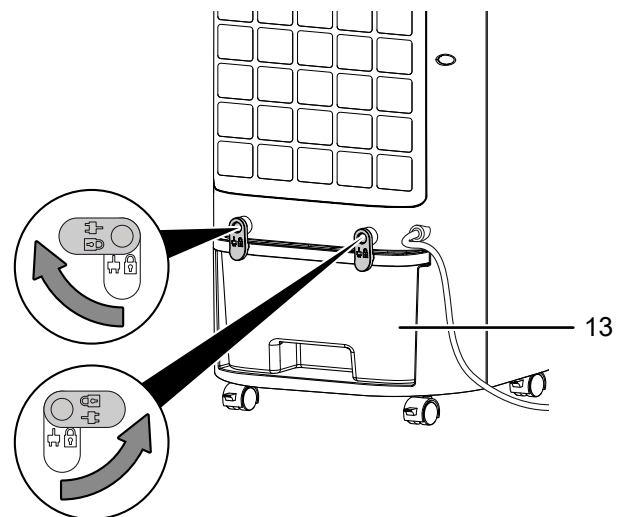

2. Remove the water tank (13) from the device.

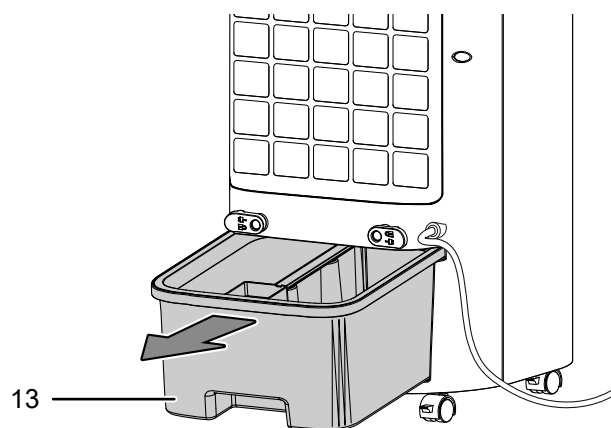

3. Thoroughly rinse the water tank (13) with citric acid (descaling agent). Allow the citric acid to work for max. 20 minutes.
4. Then rinse the inside of the device with water.
5. Dry the inside of the tank with a lint-free cloth.
6. Fill the water tank with fresh drinking water (13) if you want to continue operation (see chapter Adding water).
7. Refit the water tank (13) into the device.

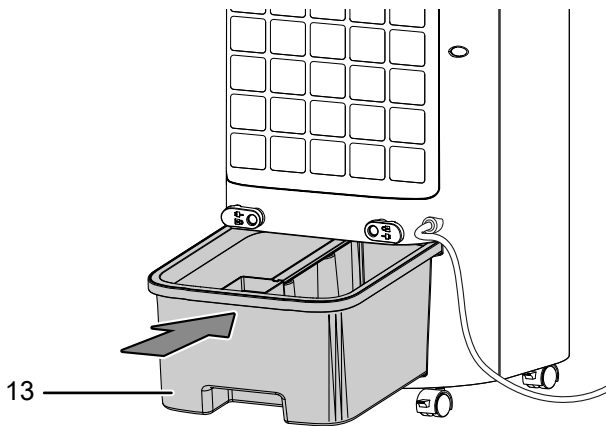

8. Lock the water tank (13) by turning the clips from their horizontal position into the vertical position.

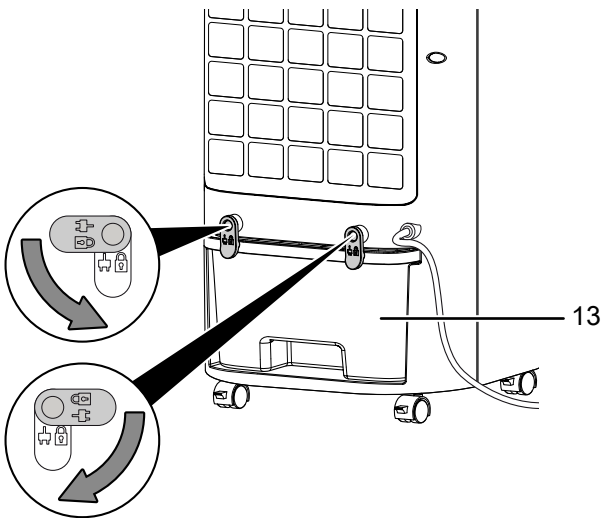

9. In doing so, make sure that the water tank (13) is inserted correctly, for otherwise the device cannot be switched back on.

### Cleaning the air filter

The air filter has to be cleaned as soon as it is dirty. This is brought to light e.g. by a reduced capacity (see chapter Errors and faults).



#### Warning

Ensure that the air filter is not worn or damaged. The corners and edges of the air filter must not be deformed or rounded. Before reinserting the air filter, make sure that it is undamaged and dry!

1. Remove the air filter (11) from the device.

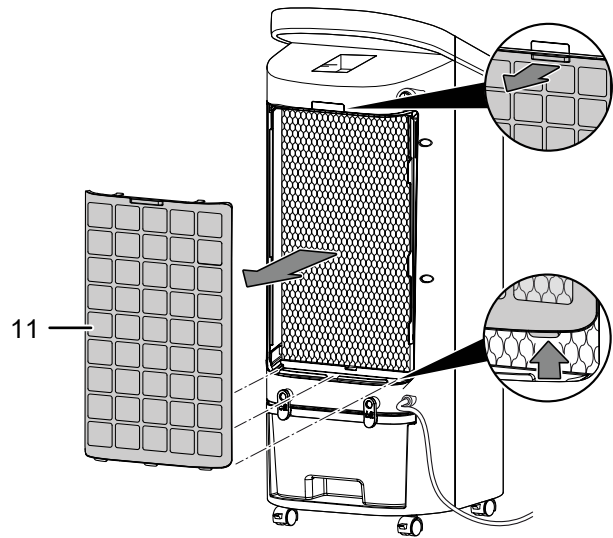

2. Clean the air filter (11) using a slightly damp, soft, lint-free cloth. If the air filter is heavily contaminated, clean it with warm water mixed with a neutral cleaning agent.
3. Allow the air filter (11) to dry completely. Do not insert a wet filter into the device!
4. Reinsert the air filter (11) into the device.

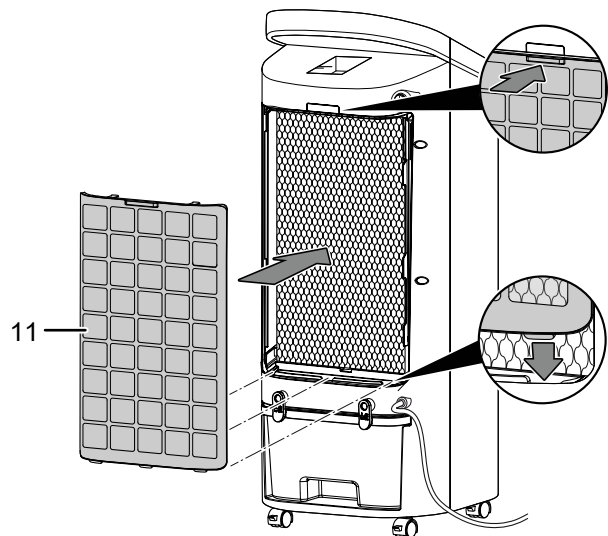

## Replacing the evaporation filter

### Notice

When set to air cooling mode, the device must not be operated without the evaporation filter, otherwise *cooling* will not work.

### Notice

Do not operate the device without an inserted air filter! Without the air filter, the inside of the device will be heavily contaminated. This could reduce the performance and result in damage to the device.

### Notice

For an even distribution of water please make sure that the top section of the evaporation filter is positioned at the top.

The evaporation filter should be replaced in case of heavy soiling.

In standard operation, the interval for replacing the evaporation filter is approx. 1 year.

Allow the evaporation filter to dry before removing it from the device.

1. Remove the air filter (11) and evaporation filter (8) from the device.

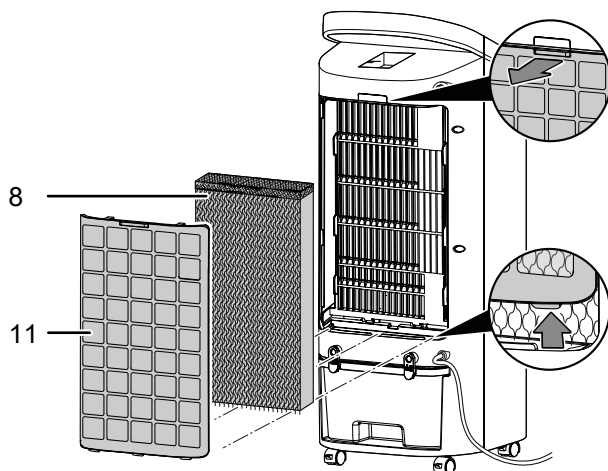

2. Dispose of used evaporation filter (8) according to the national regulations.

3. Reinsert both the air filter (11) and the new evaporation filter (8) into the device.

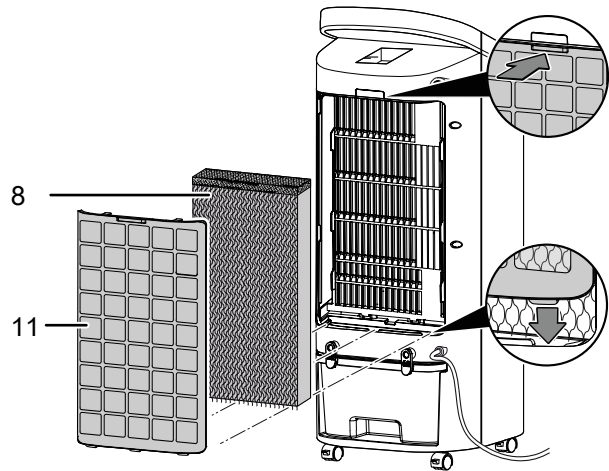

## Activities required after maintenance

If you want to continue using the device:

- Reconnect the device to the mains.

If you do not intend to use the device for a considerable time:

- Store the device according to the Transport and storage chapter.

## Technical annex

### Technical data

Parameter	Value
Evaporation capacity	600 ml/h
Heating capacity	
level 1	1400 W
level 2	2000 W
Air flow rate	118 m <sup>3</sup> /h
Mains connection	220 – 240 V / 50 Hz
Nominal current consumption	0.2 A
Power consumption	50 W
Sound pressure level (at a distance of 1 m)	55 dB(A)
Water tank capacity	4 l
Weight	6.5 kg
Dimensions (length x width x height)	248 x 310 x 684 mm
Minimum distance to walls and other objects:	
top (A):	100 cm
rear (B):	100 cm
sides (C):	100 cm
front (D):	100 cm
Remote control batteries	3V CR2032

Information requirements for electrical local space heaters

Parameter	Value / item
Model	<b>PAE 19 H</b>
<b>Heat output</b>	
Nominal heat output $P_{nom}$	2.0 kW
Minimum heat output (indicative) $P_{min}$	1.4 kW
Maximum continuous heat output $P_{max,c}$	2.0 kW
<b>Auxiliary electricity consumption</b>	
At nominal heat output $el_{max}$	NA
At minimum heat output $el_{min}$	NA
In standby mode $el_{sb}$	0.00022 kW
<b>Type of heat input</b>	
Manual heat charge control, with integrated thermostat	NA
Manual heat charge control with room and/or outdoor temperature feedback	NA
Electronic heat charge control with room and/or outdoor temperature feedback	NA
Fan assisted heat output	NA
<b>Type of heat output/room temperature control</b>	
Single-stage heat output, no room temperature control	NO
Two or more manual stages, no room temperature control	NO
With mechanic thermostat room temperature control	NO
With electronic room temperature control	YES
With electronic room temperature control plus day timer	NO
With electronic room temperature control plus week timer	NO
<b>Other control options</b>	
Room temperature control, with presence detection	NO
Room temperature control, with open window detection	NO
With distance control option	NO
With adaptive start control	NO
With working time limitation	YES
With black bulb sensor	NO
Contact details	Trotec GmbH Grebener Straße 7 D-52525 Heinsberg

NA = not applicable

## Disposal

Always dispose of packing materials in an environmentally friendly manner and in accordance with the applicable local disposal regulations.



The icon with the crossed-out waste bin on waste electrical or electronic equipment is taken from Directive 2012/19/EU. It states that this device must not be disposed of with the household waste at the end of its life. You will find collection points for free return of waste electrical and electronic equipment in your vicinity. The addresses can be obtained from your municipality or local administration. You can also find out about other return options that apply for many EU countries on the website <https://hub.trotec.com/?id=45090>. Otherwise, please contact an official recycling centre for electronic and electrical equipment authorised for your country.

The separate collection of waste electrical and electronic equipment aims to enable the re-use, recycling and other forms of recovery of waste equipment as well as to prevent negative effects for the environment and human health caused by the disposal of hazardous substances potentially contained in the equipment.



In the European Union, batteries and accumulators must not be treated as domestic waste, but must be disposed of professionally in accordance with Directive 2006/66/EC of the European Parliament and of the Council of 6 September 2006 on batteries and accumulators. Please dispose of batteries and accumulators according to the relevant legal requirements.

### Only for United Kingdom

According to Waste Electrical and Electronic Equipment Regulations 2013 (SI 2013/3113) (as amended) and the Waste Batteries and Accumulators Regulations 2009 (SI 2009/890) (as amended), devices that are no longer usable must be collected separately and disposed of in an environmentally friendly manner.

Trotec GmbH

Grebener Str. 7  
D-52525 Heinsberg

☎ +49 2452 962-400

☎ +49 2452 962-200

✉ [info@trotec.com](mailto:info@trotec.com)

[www.trotec.com](http://www.trotec.com)